

C€ -EN IEC 60598-1 IEC/TR 62778:2014 650°C Classe II
IEC/EN 60598-2-22 "eme.3F-Filippi.com"

3F Trittico WH - BK op. 2 - 3

cod.		kg
6104	3F Trittico WH 12+12+15/835 DALI H300	3.4
6105	3F Trittico BK 12+12+15/835 DALI H300	3.4
6107	3F Trittico WH 12+12+15/835 DALI H500	3.7
6108	3F Trittico BK 12+12+15/835 DALI H500	3.7
6110	3F Trittico WH 12+12+15/835 DALI H800	4.0
6111	3F Trittico BK 12+12+15/835 DALI H800	4.0

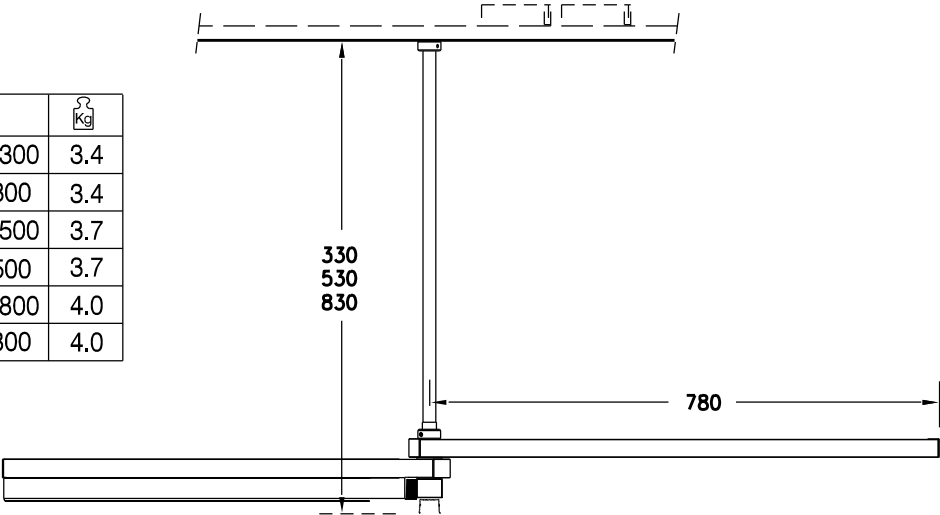

Acc. cod. A0830 - A0831 op. 4 - 7

cod.	Accessori	kg
A0830	Fiss. Trittico cartongesso WH	0.8
A0831	Fiss. Trittico cartongesso BK	0.8

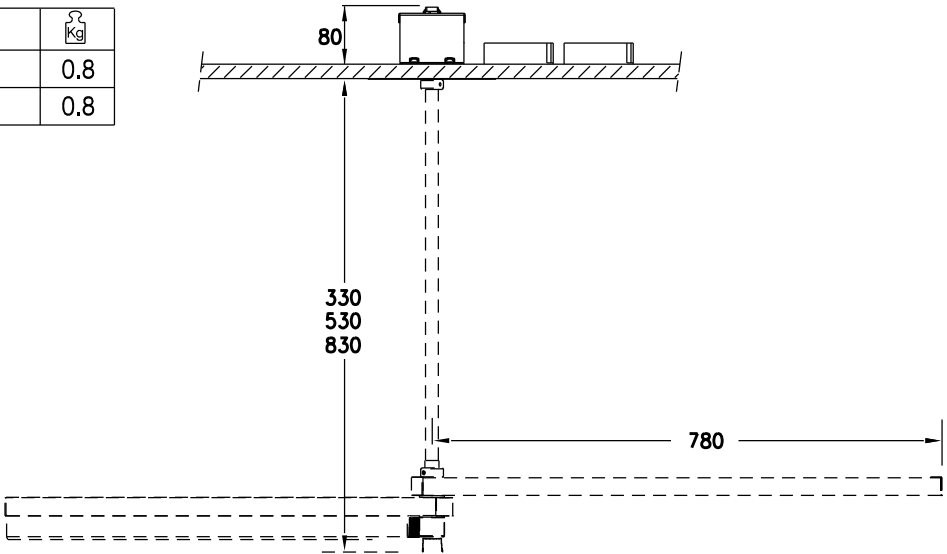

This product contains a light source of energy efficiency class < <https://www.3f-filippi.com/en/Search> >
Questo prodotto contiene una sorgente luminosa di classe di efficienza energetica < <https://www.3f-filippi.com/it/Ricerca> >
Ce produit contient une source lumineuse de classe d'efficacité énergétique < <https://www.3f-filippi.com/fr/Recherche> >
Dieses Produkt enthält eine Lichtquelle der Energieeffizienzklasse < <https://www.3f-filippi.com/de/Suche> >
Este producto contiene una fuente de luz de clase de eficiencia energética < <https://www.3f-filippi.com/es/Busqueda> >

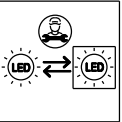

Sorgente luminosa (solo LED) sostituibile da un professionista
Replaceable (LED only) light source by a professional
Source lumineuse (LED uniquement) remplaçable par un professionnel
Fuente luminosa reemplazable (solo LED) por un profesional
Austauschbare (nur LED) Lichtquelle durch einen Fachmann

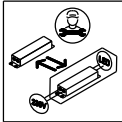

Alimentatore sostituibile da un professionista
Replaceable control gear by a professional
Boîtier de commande remplaçable par un professionnel
Equipo de control reemplazable por un profesional
Austauschbare Vorschaltgeräte durch einen Fachmann

Acc. cod. A0828

op. 8 - 12

cod.	Accessori	kg
A0828	Fiss. Trittico Pannelli metallici 60x60	1.4

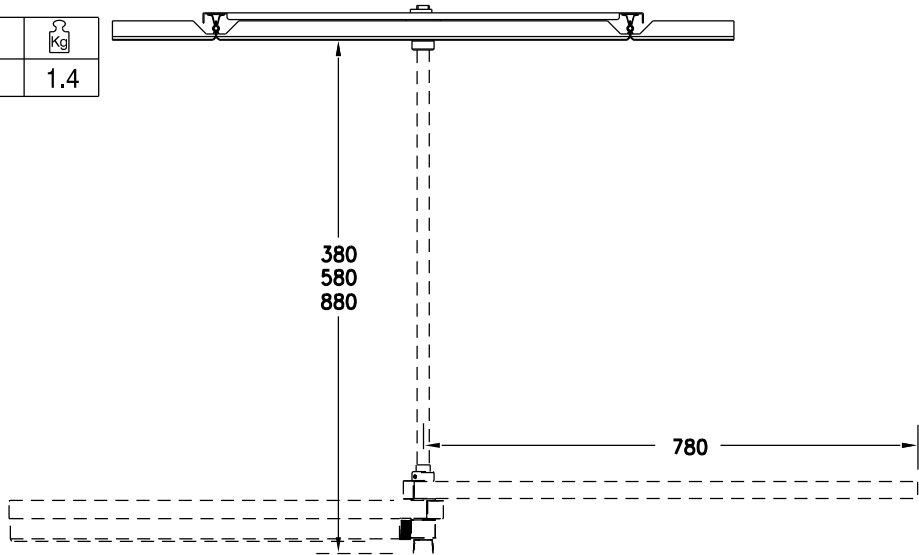

Acc. cod. A0829

op. 13 - 17

cod.	Accessori	kg
A0829	Fiss. Trittico Pannelli fibra miner. 60x60	1.9

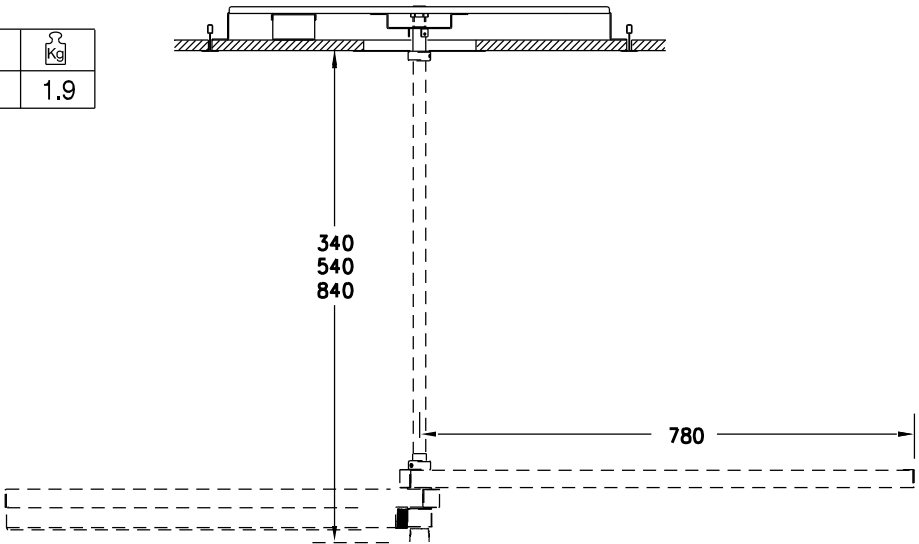

- ATTENZIONE : Non toccare i moduli Led - Maneggiare con cautela
Dispositivo sensibile alle scariche elettrostatiche - Usare guanti antistatici
Non esporre i moduli LED a polveri e/o sostanze chimicamente aggressive
quali Cloro, Zolfo, Ammoniaca, Oli Minerali, ecc.
- ATTENTION : Ne touchez pas les modules Led - Manipuler avec précaution
Dispositif sensible aux décharges électrostatiques - Utiliser gants antistatiques
N'exposez pas les modules LED aux poussières et/ou aux produits chimiques
agressifs comme chlore, soufre, ammoniac, huiles minérales, etc.
- ATENCION : No toque los módulos Led - Tratar con cuidado
Dispositivo sensible a las descargas electrostáticas - Use guantes antiestáticos
No exponga los módulos LED a polvos y/o sustancias químicamente agresivas
como cloro, azufre, amoniaco, aceites minerales, etc.

- ATTENTION : Do not touch the Led modules - Observe precautions for handling
Device sensitive to electrostatic discharge - Use antistatic gloves
Do not expose LED modules to dust and/or chemically aggressive substances
such as Chlorine, Sulphur, Ammonia, Mineral Oils, etc.
- ACHTUNG : LED-module nicht berühren - mit Vorsicht behandeln
Gerät empfindlich gegen elektrostatische Entladung - Verwenden Sie antistatische
Handschuhe
Setzen Sie die LED-Module keinen Staubpartikeln und/oder aggressiven
chemischen Substanzen wie Chlor, Schwefel, Ammoniak, Mineralölen usw. aus.

L'apparecchio non deve essere smaltito come rifiuto urbano, mediante cassonetto,
ma e' soggetto a raccolta separata.
Il mancato rispetto di questa norma e' sanzionato dalla legge e potrebbe provocare
potenzialmente effetti negativi sia per l'ambiente sia sulla salute umana.
L'appareil ne doit pas être éliminé comme ordures ménagères, dans la poubelle, mais
il est sujet à collecte sélective.
La non-observation de cette disposition est sanctionnée par la loi et peut provoquer
en puissance effets négatifs soit pour l'ambiance soit pour la santé humaine.
La luminaria no debe ser desechada como residuo urbano, sino a través de un gestor
de residuos, ya que es objeto de recogida selectiva.
El incumplimiento de esta norma está sancionado por la ley y puede causar
potencialmente daños tanto al medio ambiente como a la salud.



The luminaire must not be eliminated as urban waste, by means of refuse body,
rather it is object of separate collection.
The non-observance of this rule is sanctioned by the law and potentially could
cause negative effects both on the environment and on human health.
Die Leuchte muss als Sondermüll entsorgt werden!
Die Nichteinhaltung dieser Bestimmung kann strafrechtlich verfolgt werden.
Ferner verursacht eine nicht gerechte Entsorgung negative Folgen für die
Umwelt und die menschliche Gesundheit.

DECRETO LEGISLATIVO 14 marzo 2014, n. 49. Attuazione della
direttiva 2012/19/UE (Revisione della Direttiva 2002/96/UE) e s.m.i.

1

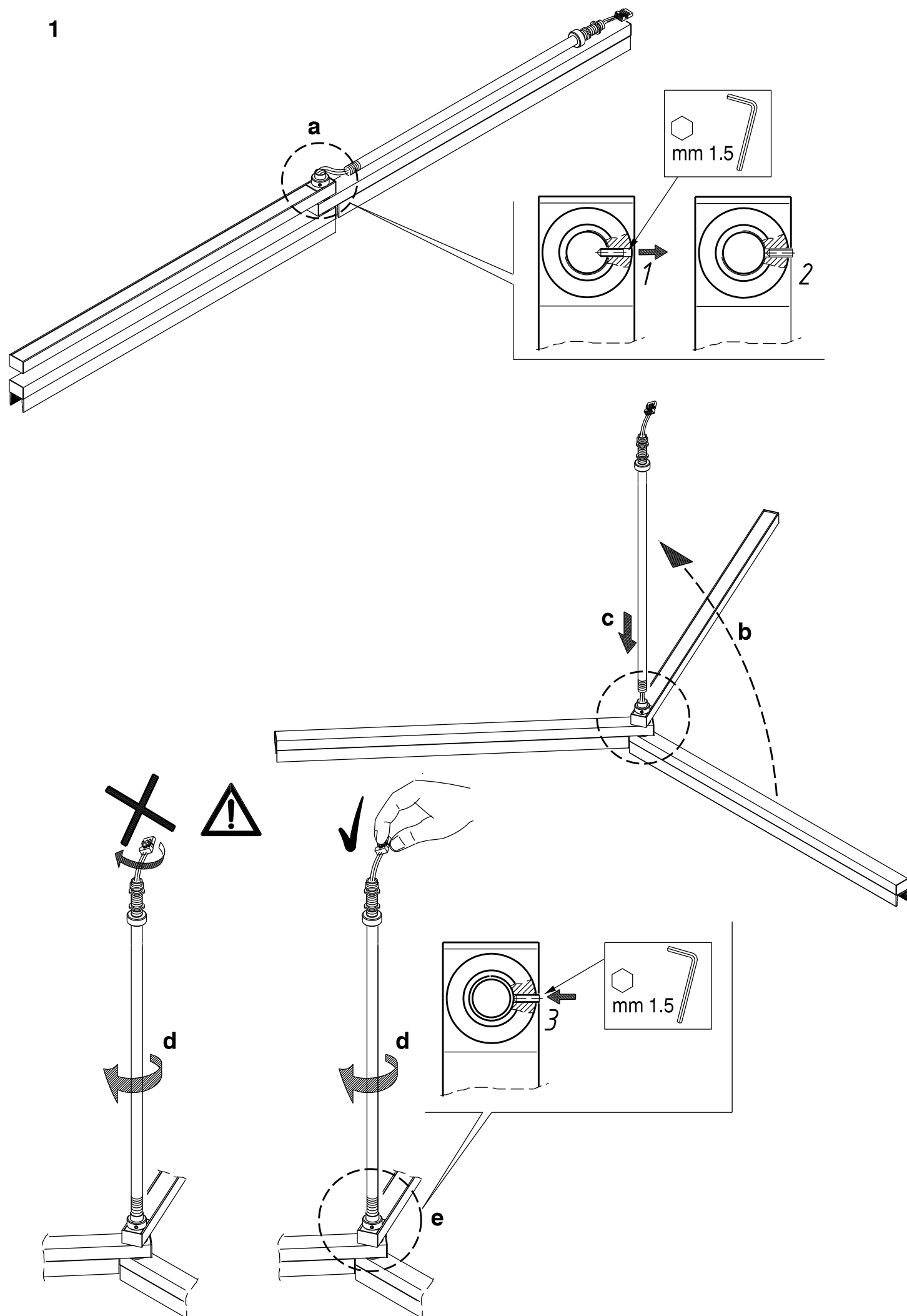

3F Trittico WH - BK

op. 2 - 3

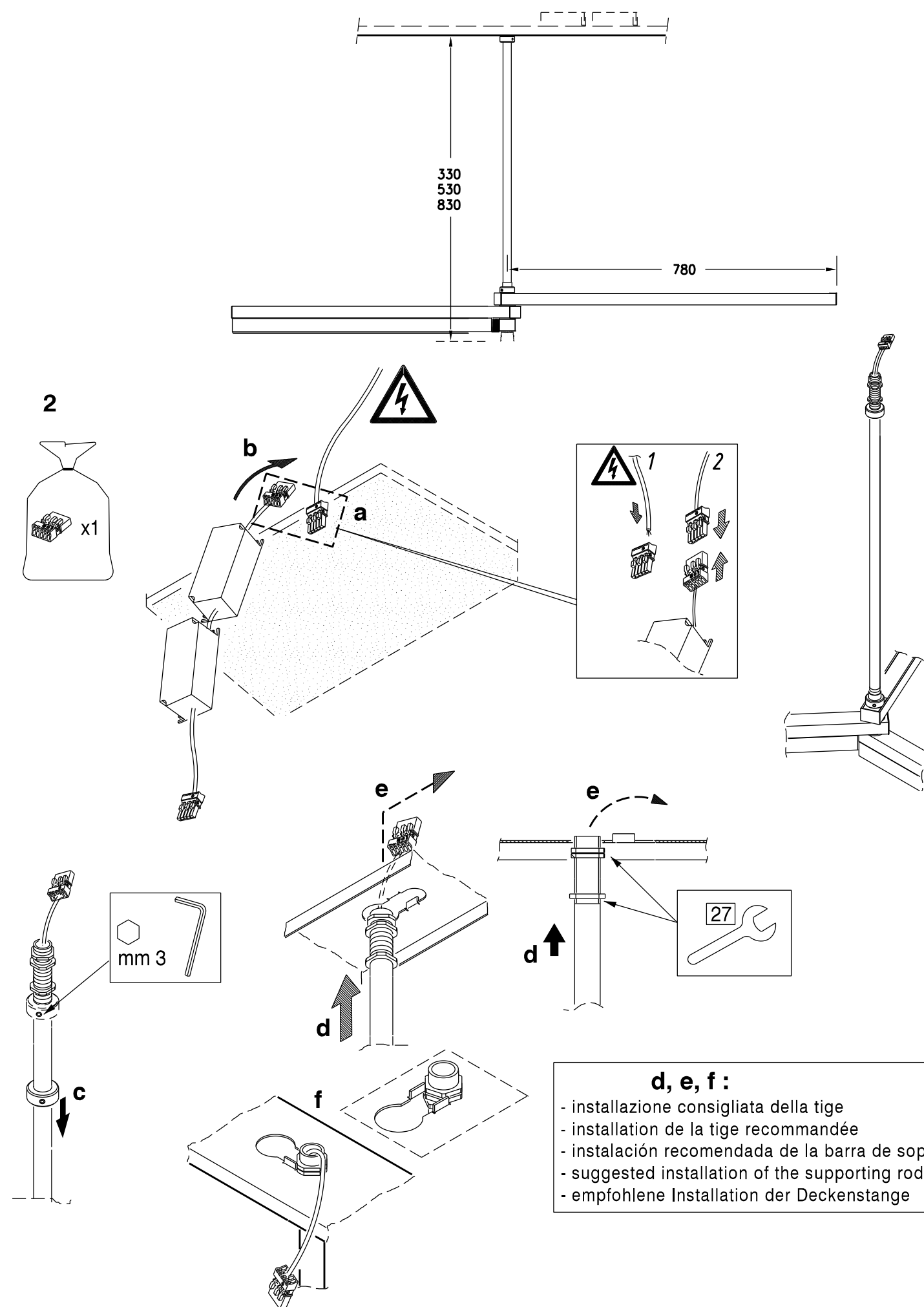

- d, e, f:**
- installazione consigliata della tige
 - installation de la tige recommandée
 - instalación recomendada de la barra de soporte
 - suggested installation of the supporting rod
 - empfohlene Installation der Deckenstange

3

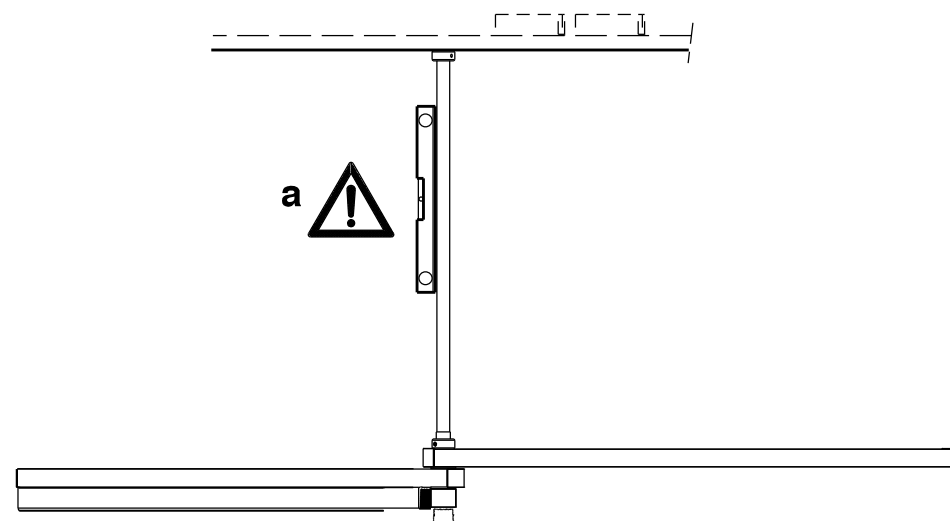

Acc. cod. A0830 - A0831 op. 4 - 7

cod.	Accessori	Peso Kg
A0830	Fiss. Trittico cartongesso WH	0.8
A0831	Fiss. Trittico cartongesso BK	0.8

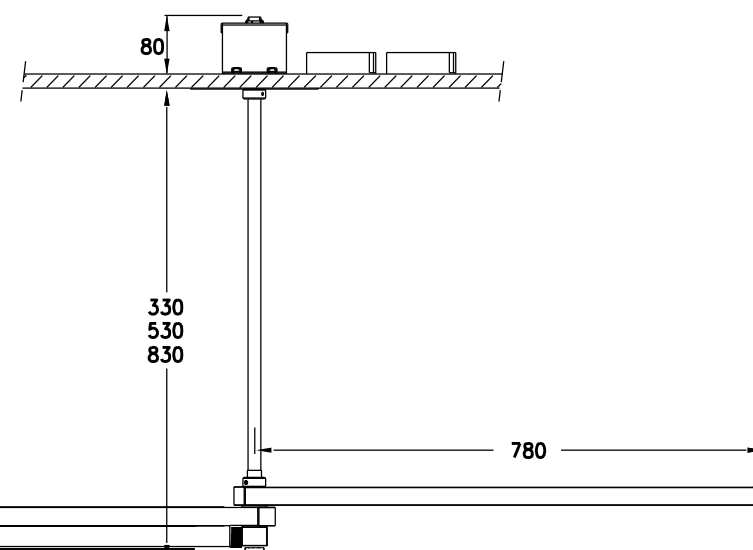

4

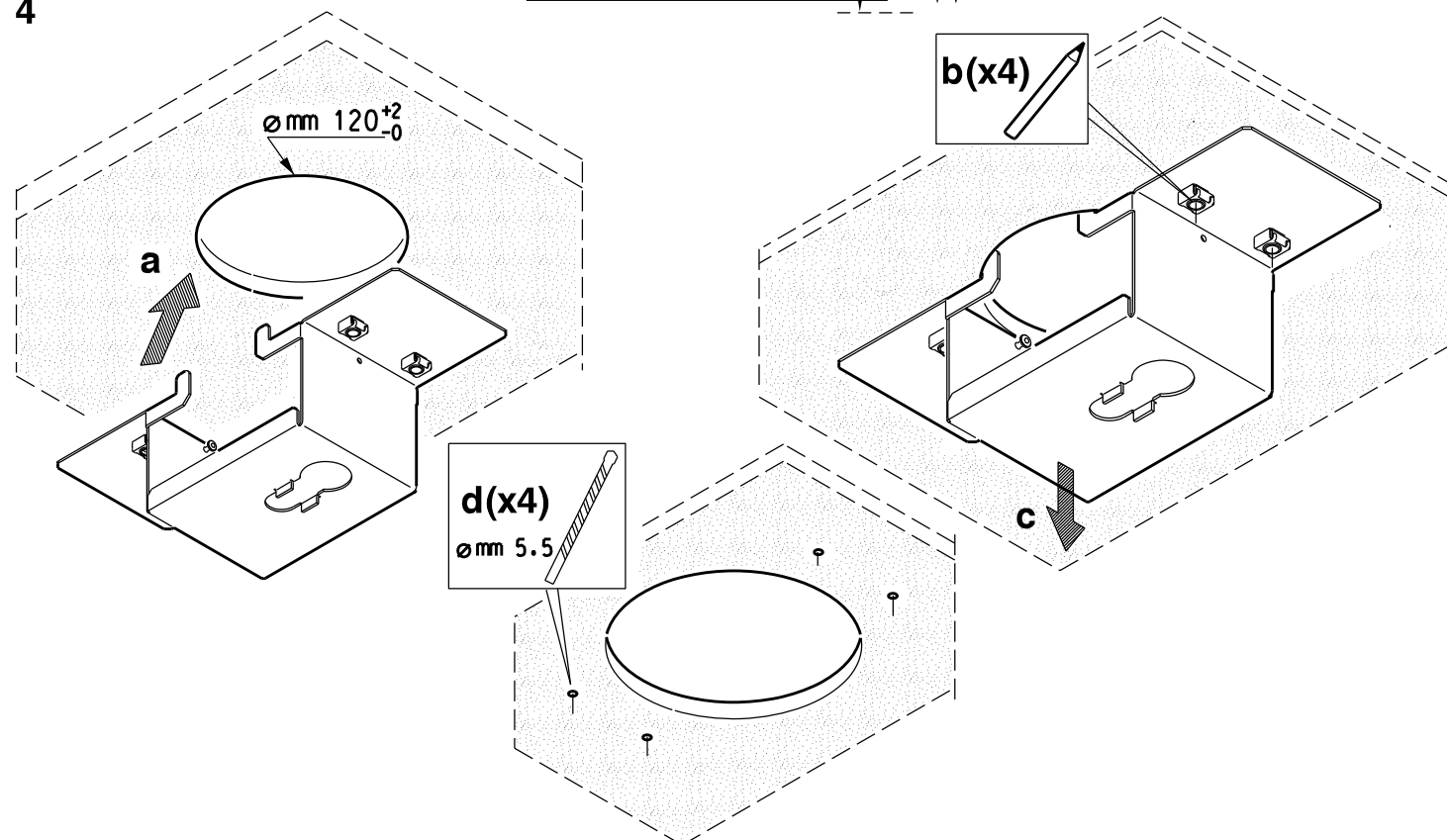

5

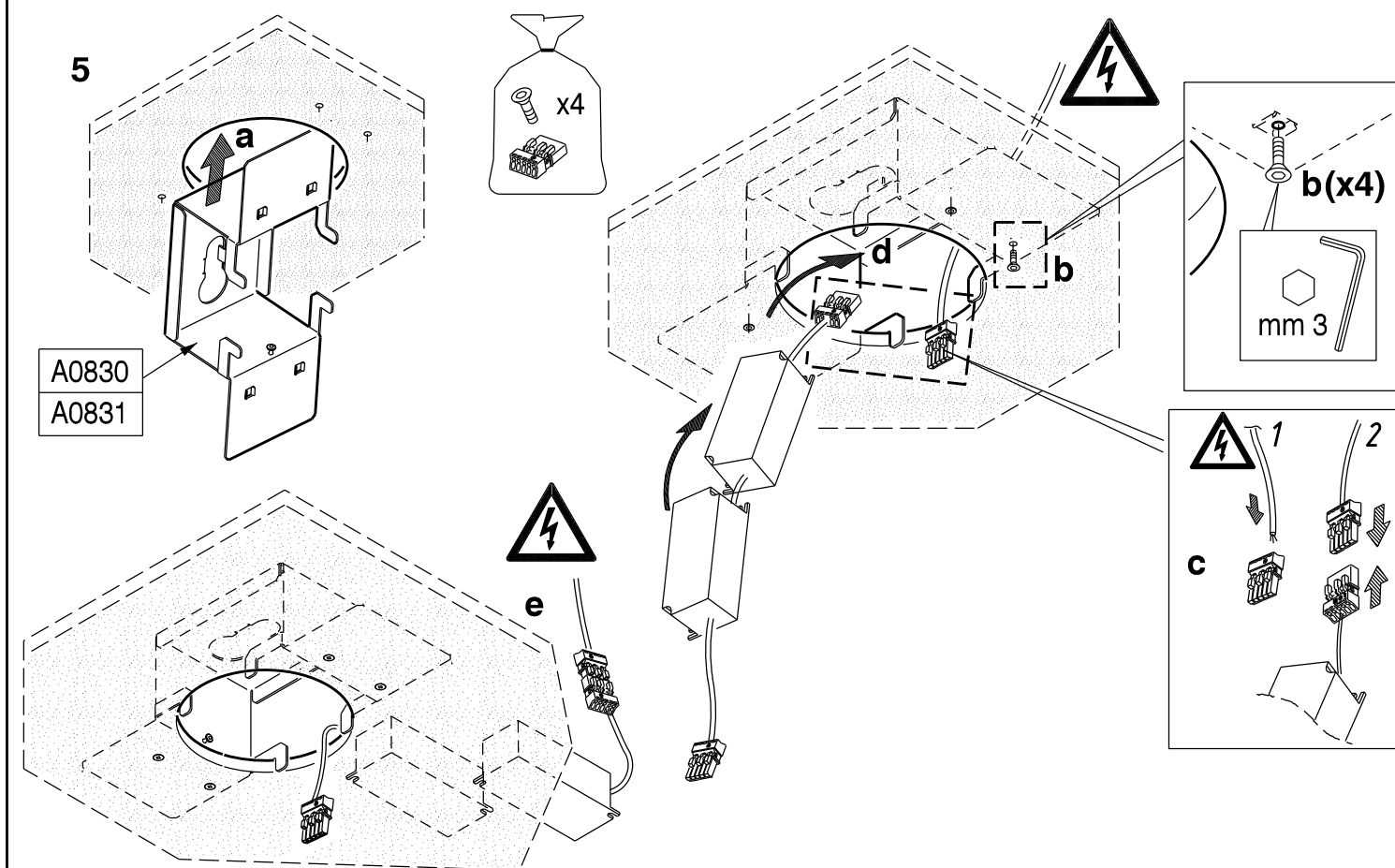

6

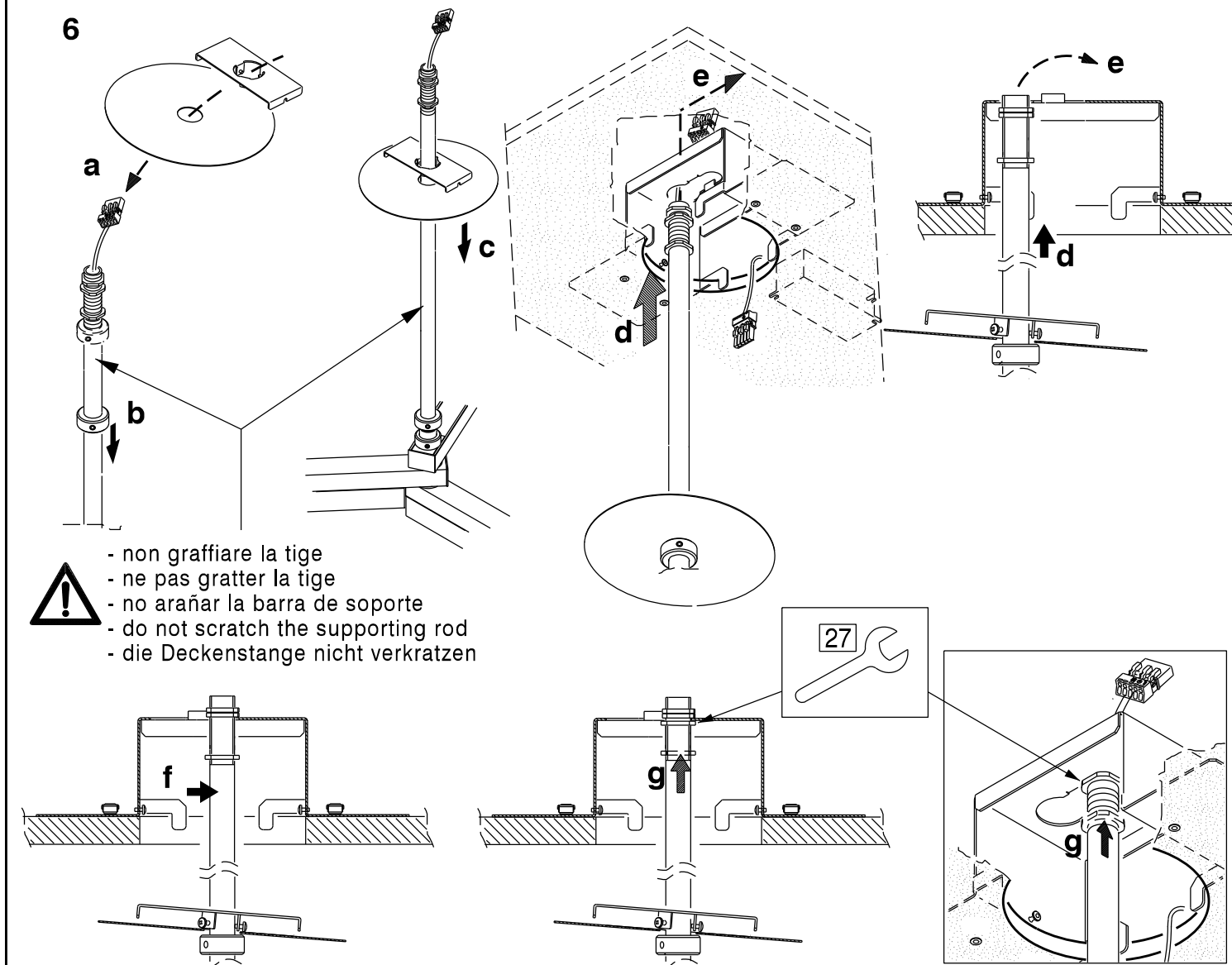

...6

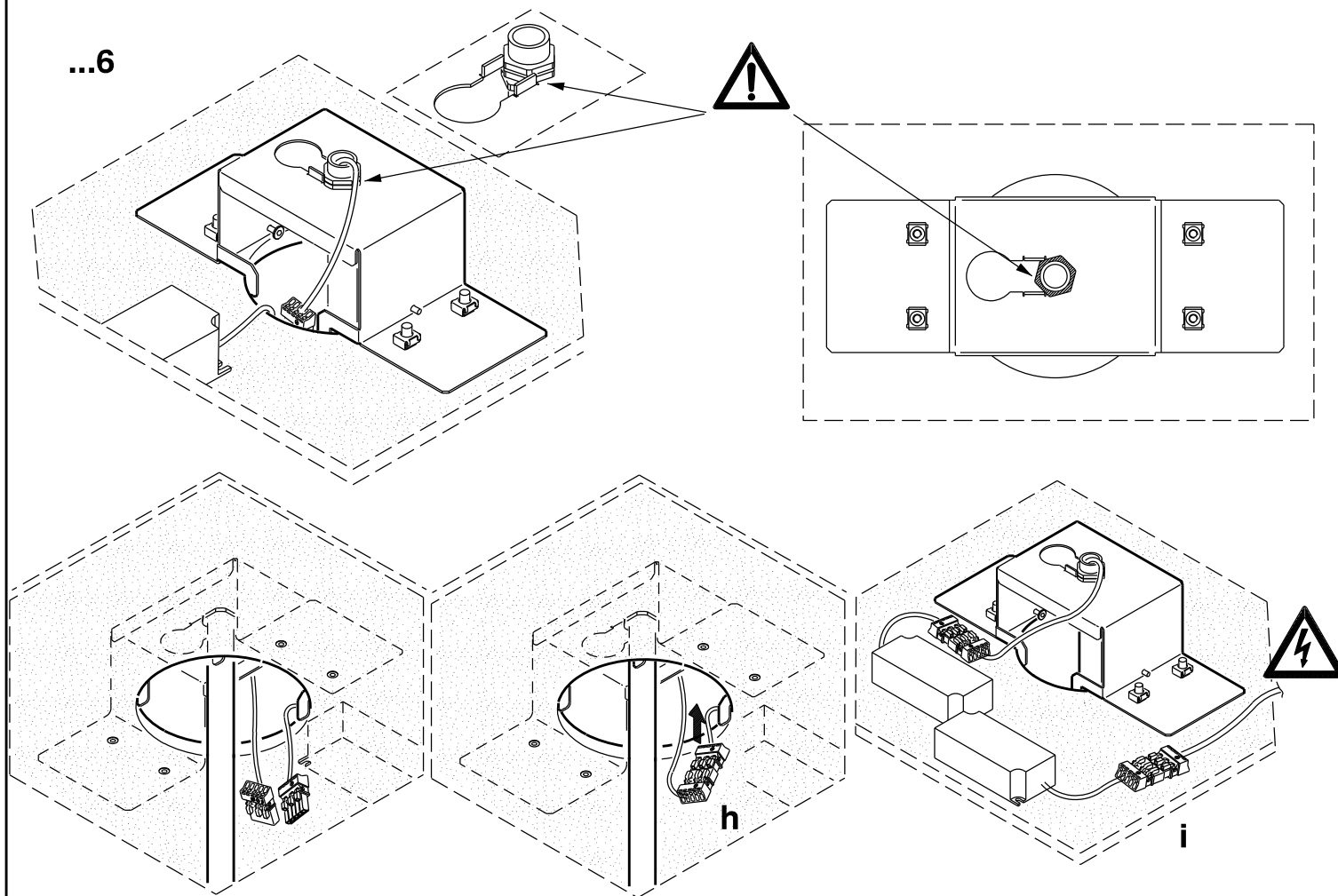

7

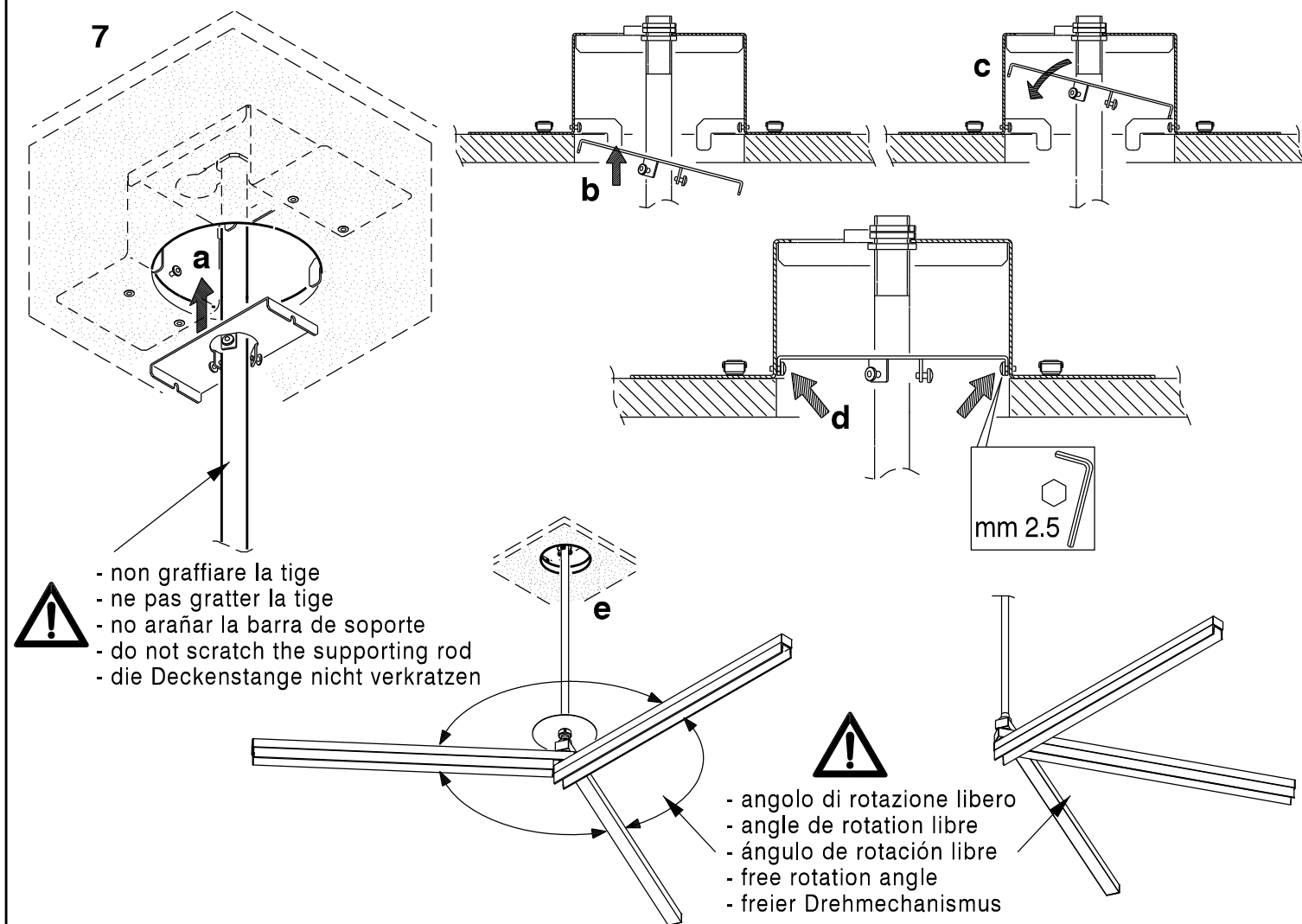

...7

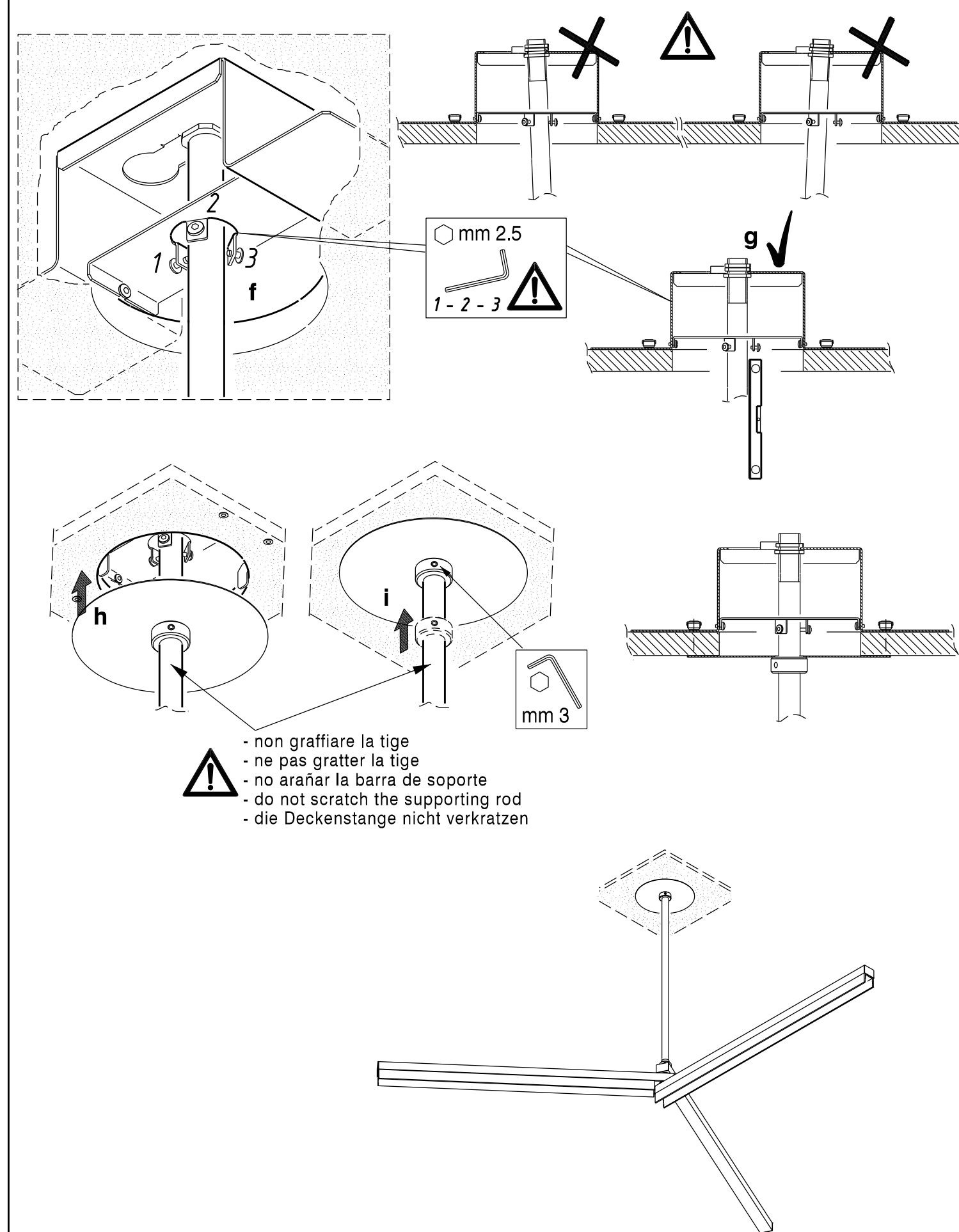

Acc. cod. A0828

op. 8 - 12

cod.	Accessori	
A0828	Fiss. Trittico Pannelli metallici 60x60	1.4

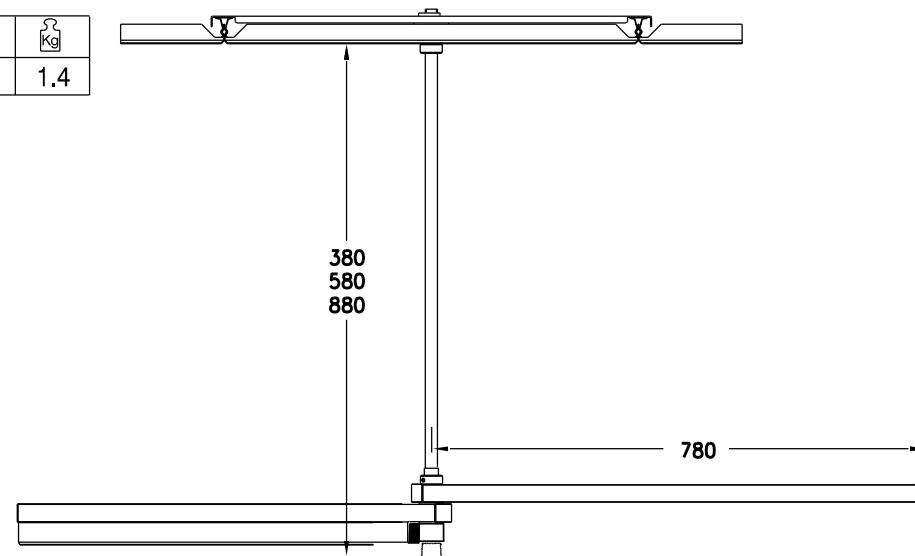

8

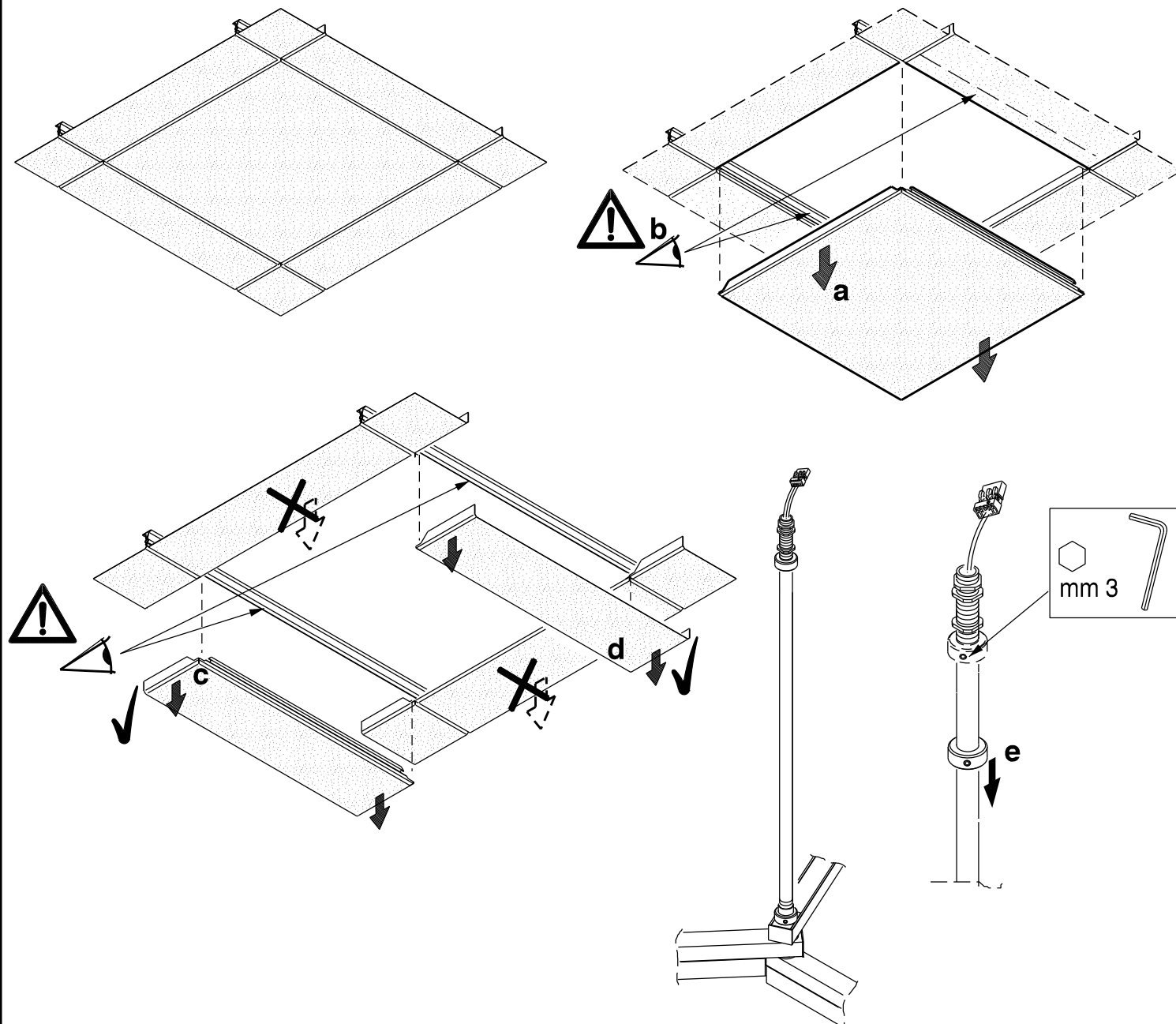

9

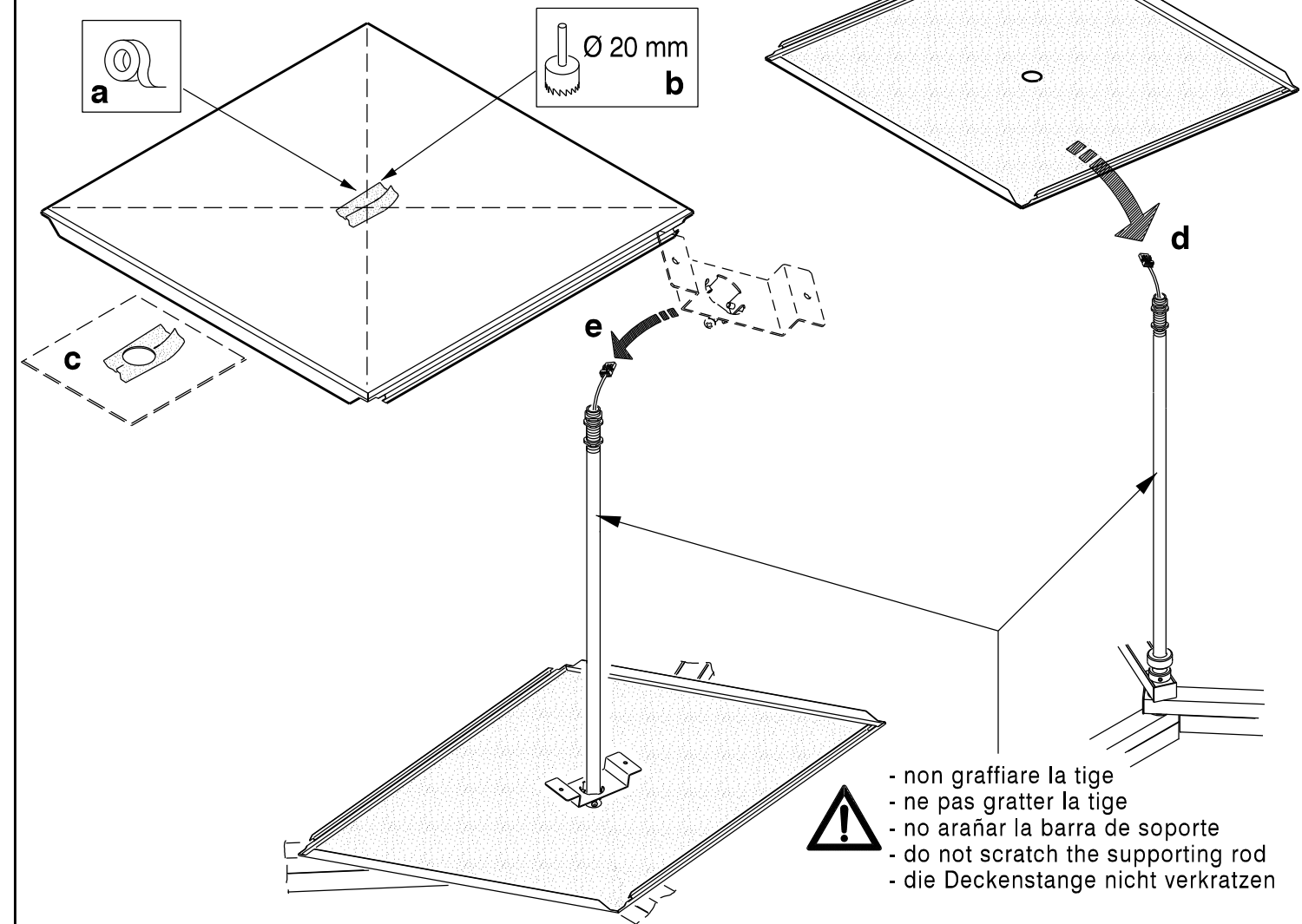

10

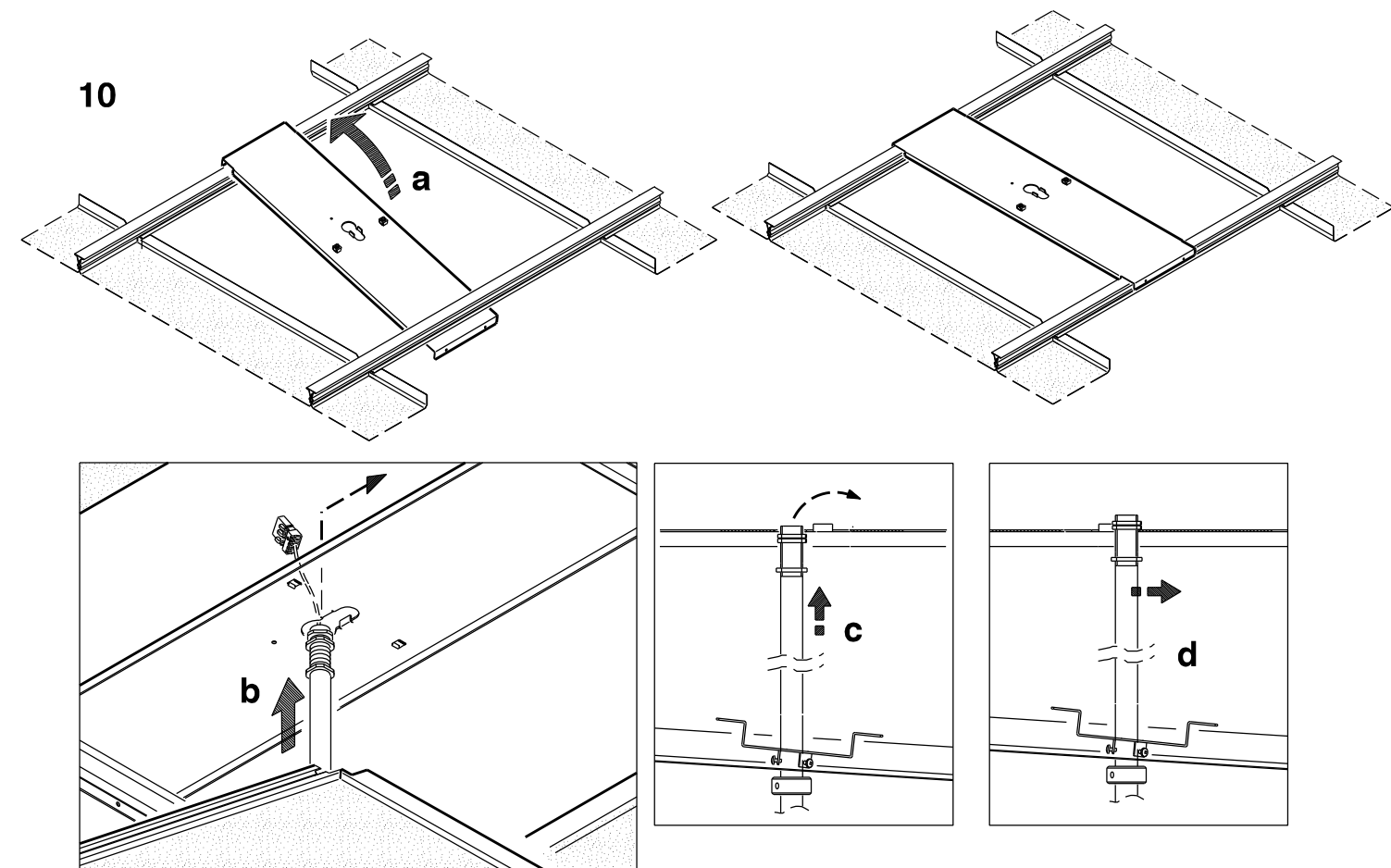

...10

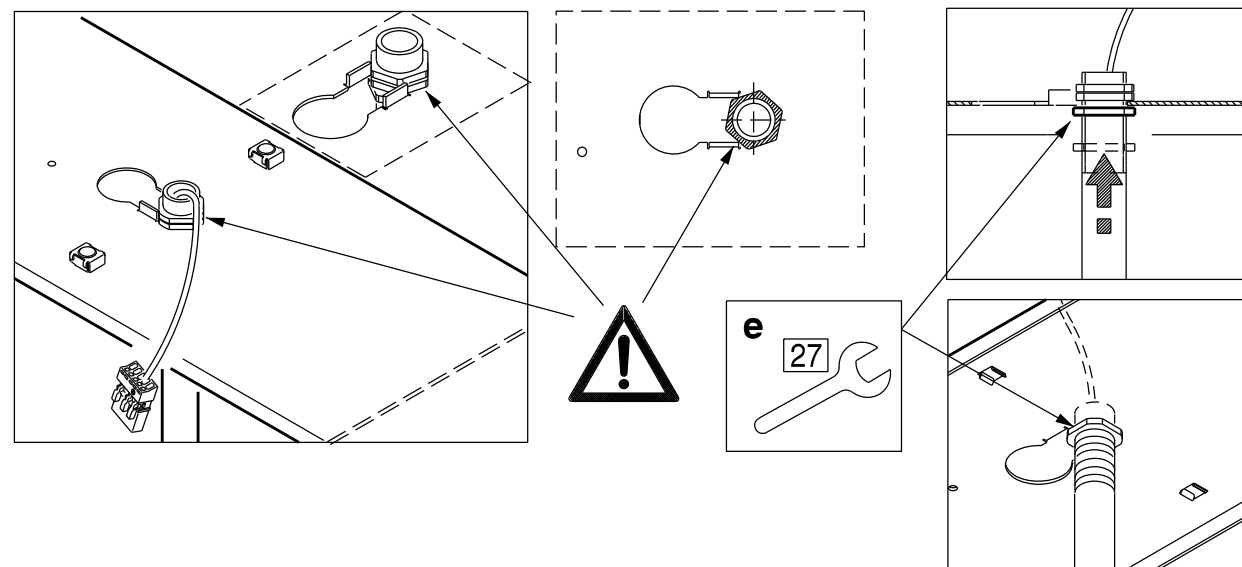

11

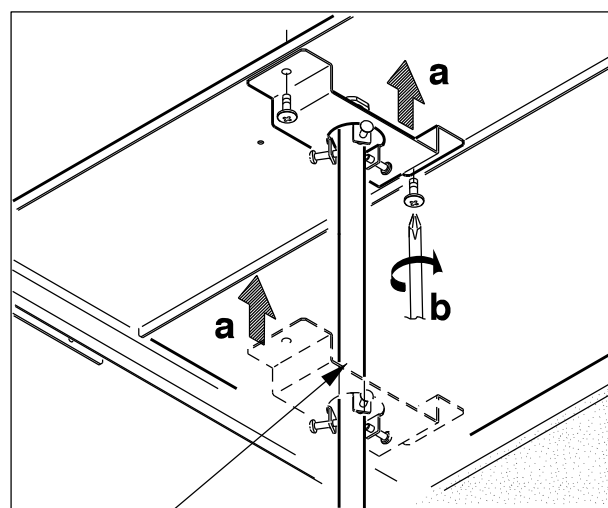

- angolo di rotazione libero
- angle de rotation libre
- ángulo de rotación libre
- free rotation angle
- freier Drehmechanismus

- ! - non graffiare la tige
- ne pas gratter la tige
- no arañar la barra de soporte
- do not scratch the supporting rod
- die Deckenstange nicht verkratzen

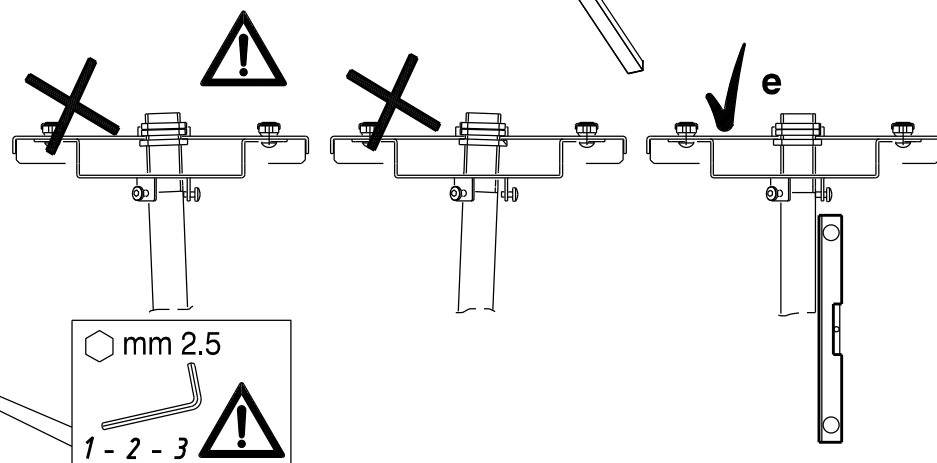
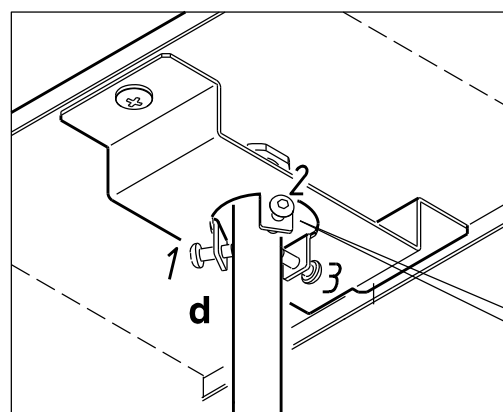

...11

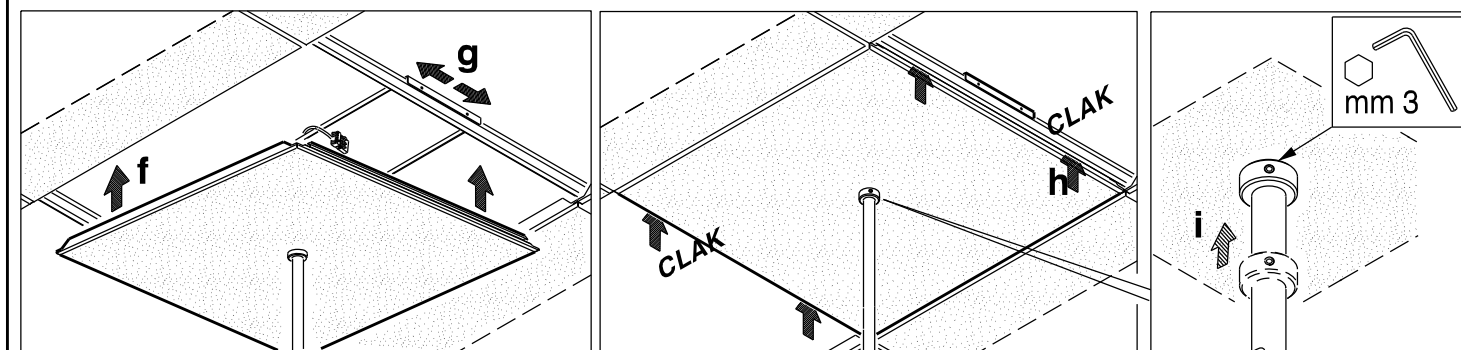

12

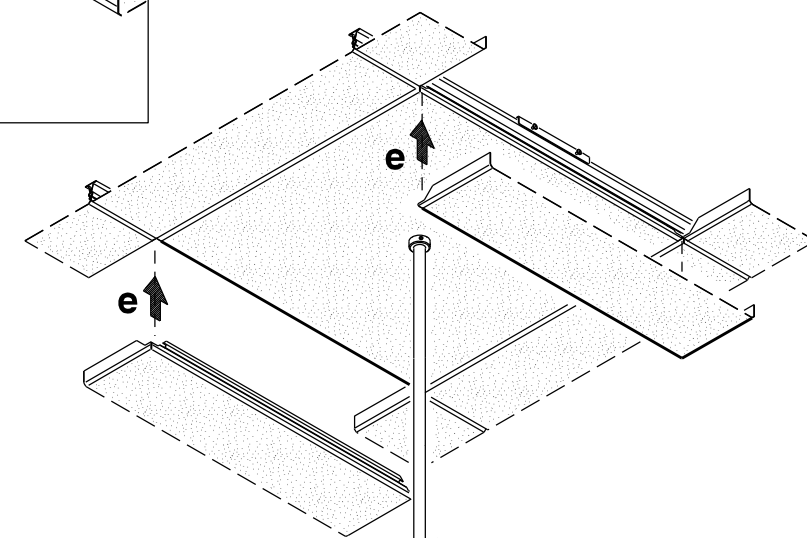
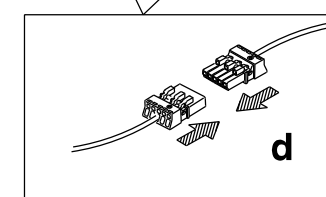
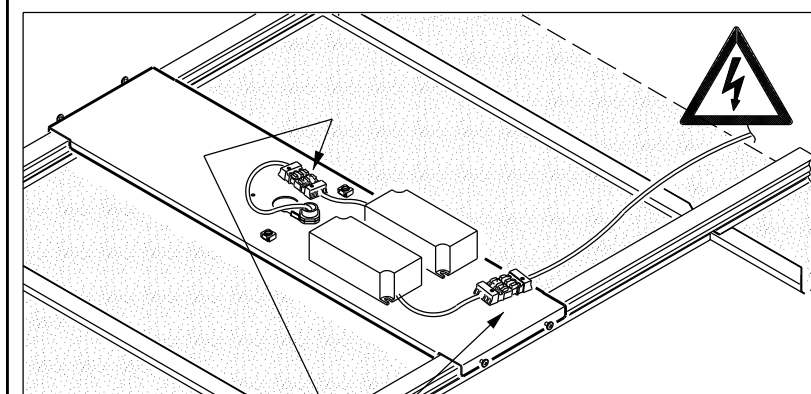
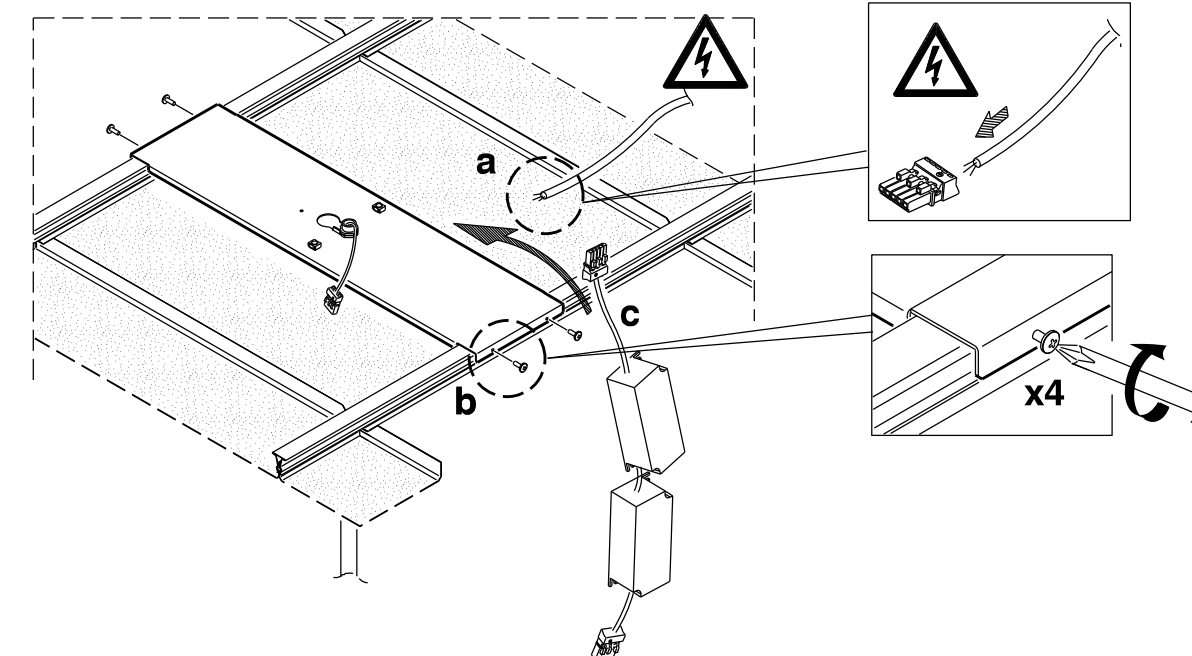
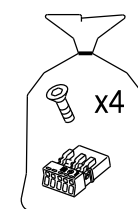

Acc. cod. A0829

op. 13 - 17

cod.	Accessori	
A0829	Fiss. Trittico Pannelli fibra miner. 60x60	1.9

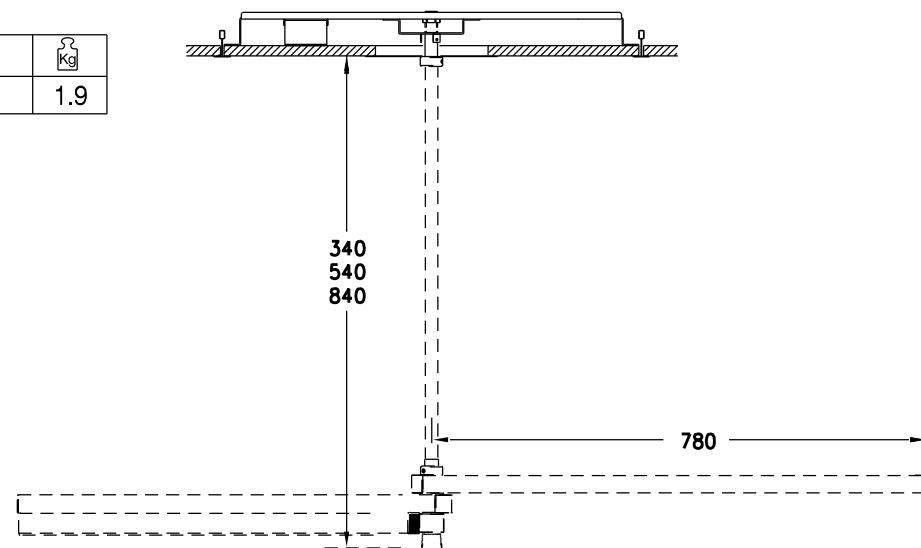

13

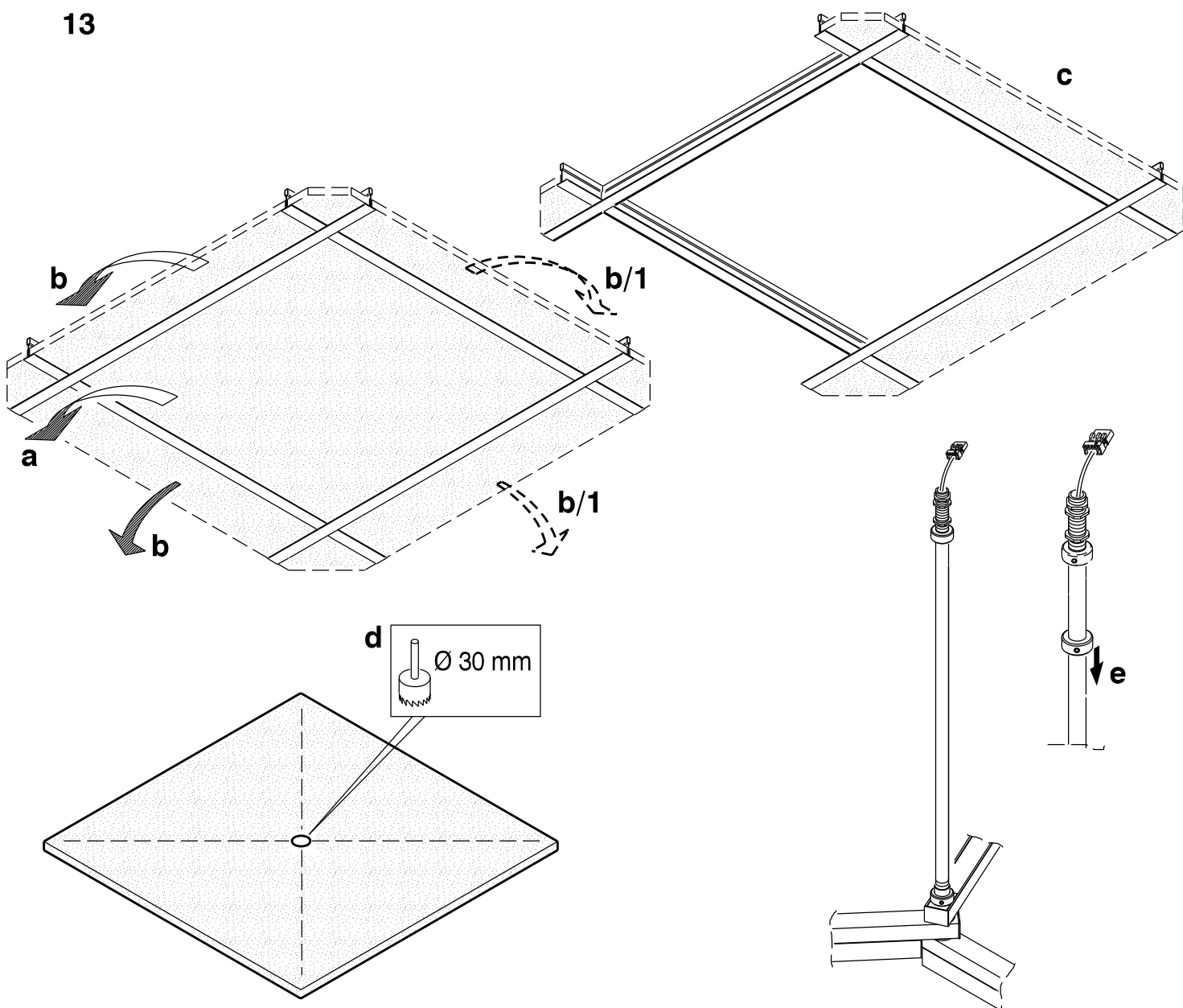

14

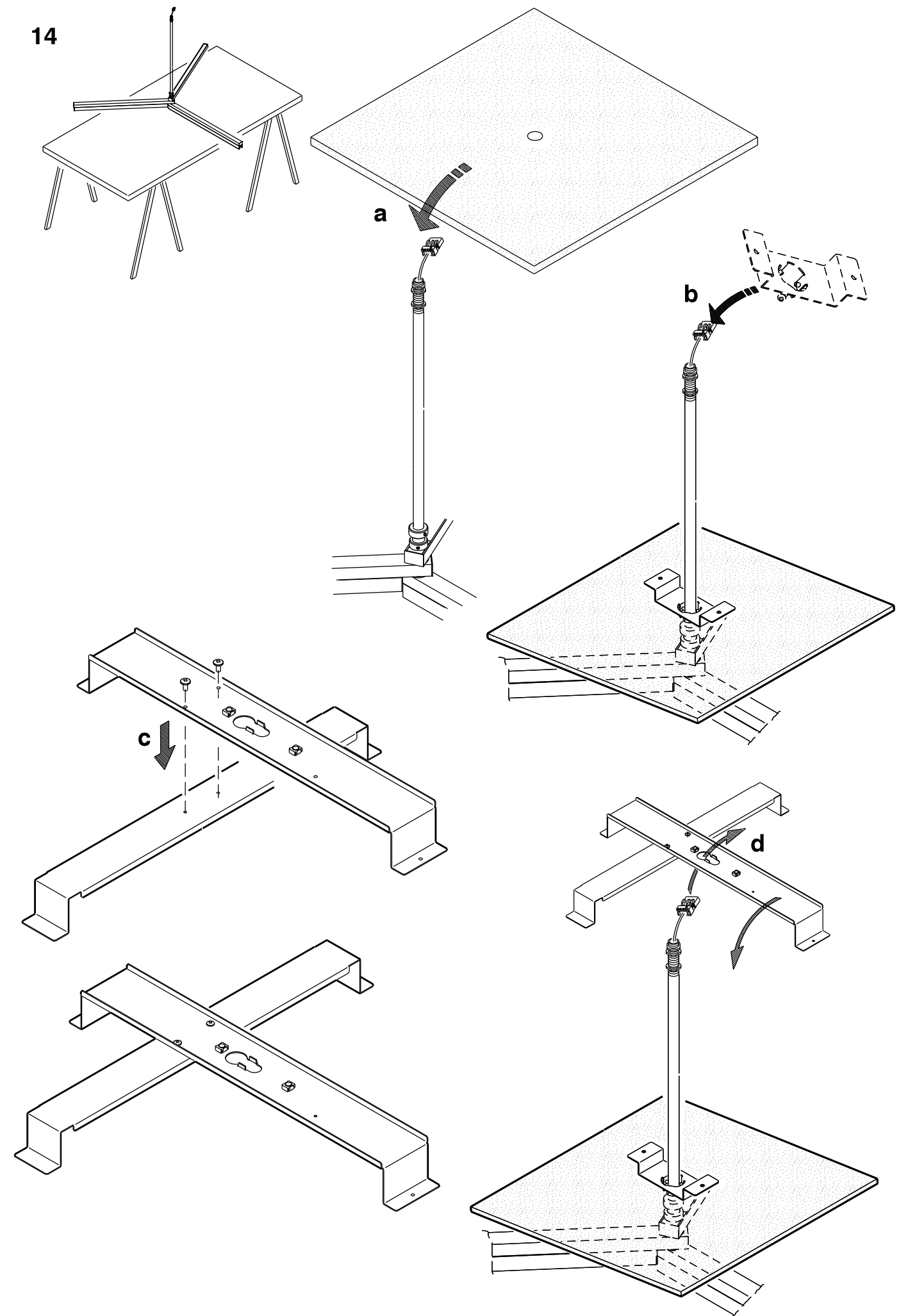

...14

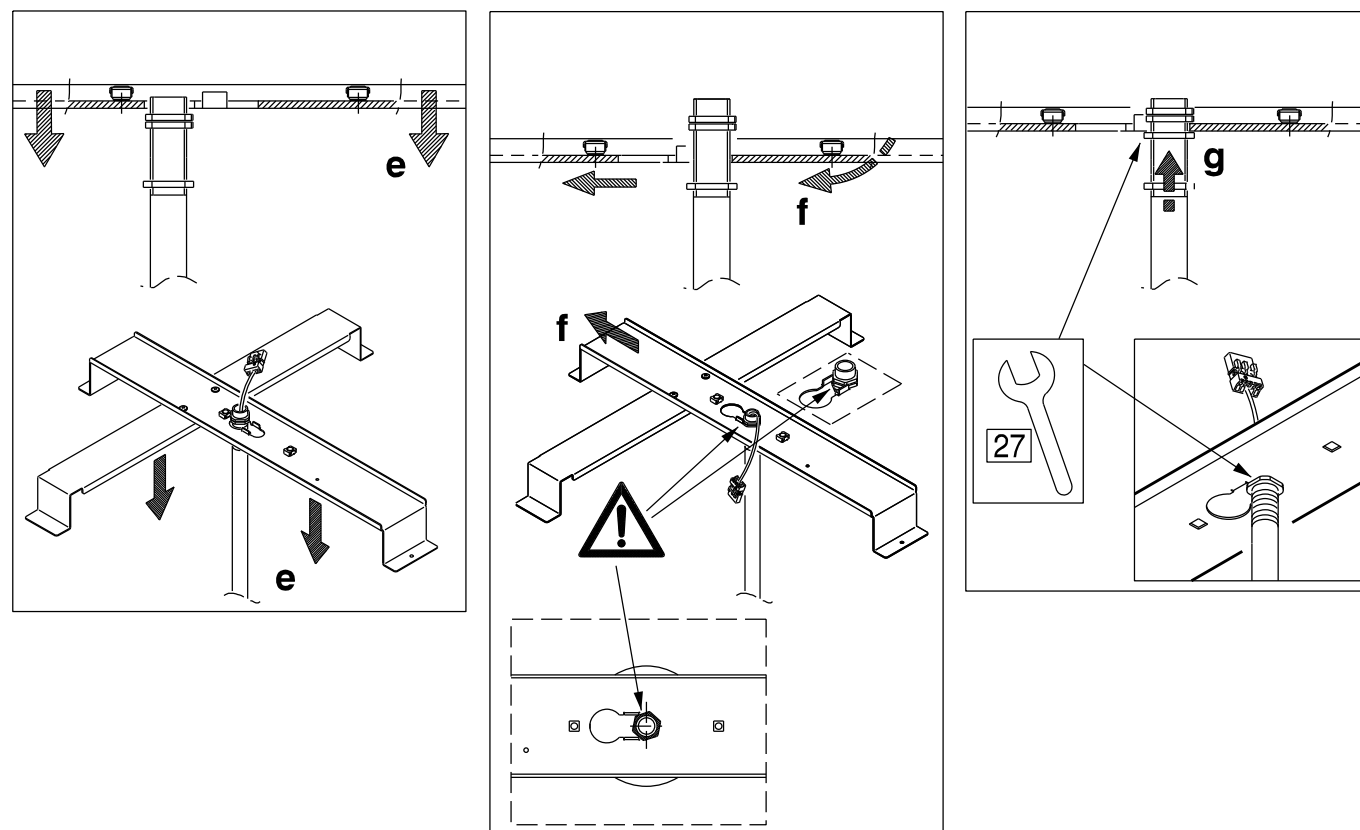

15

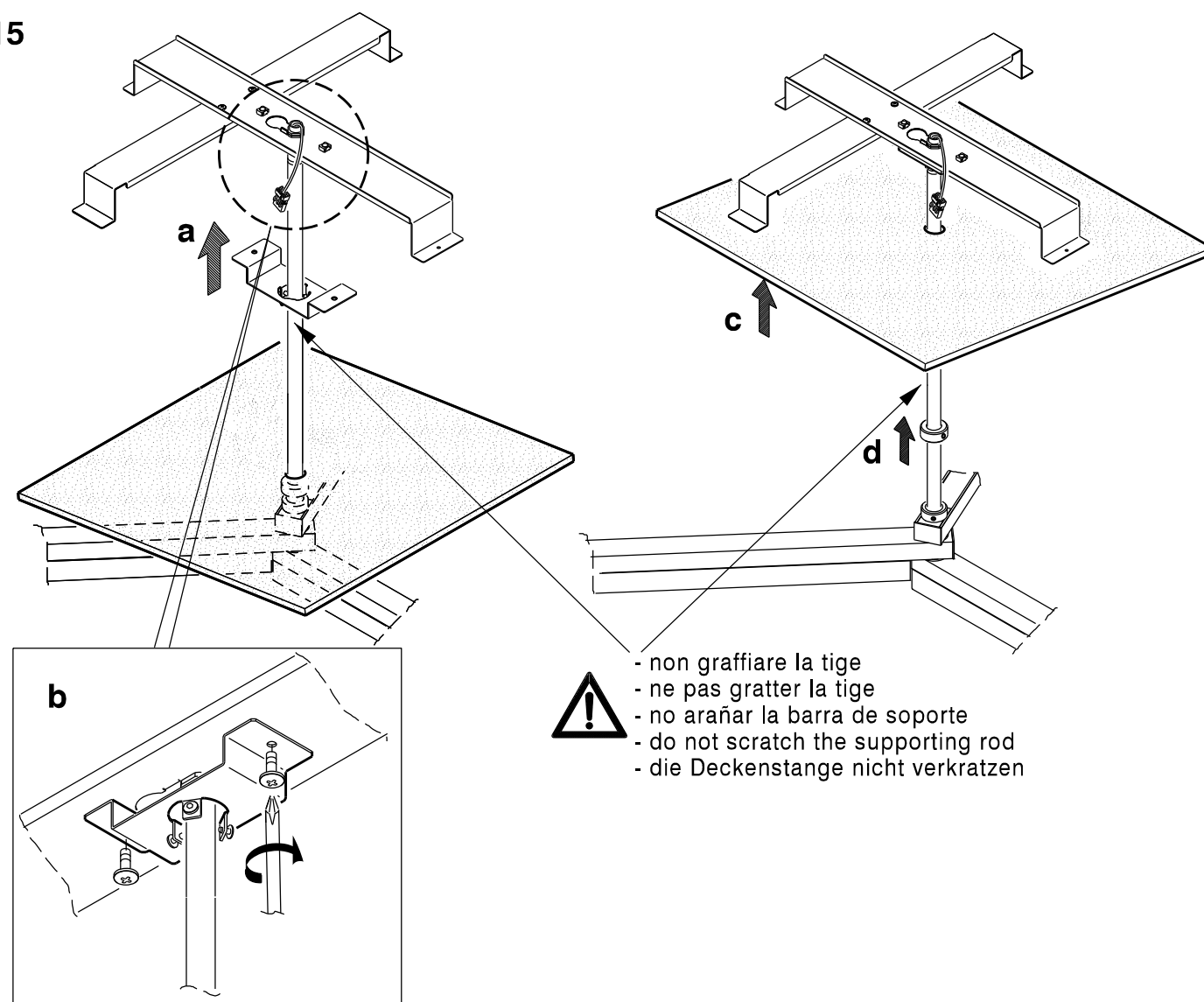

...15

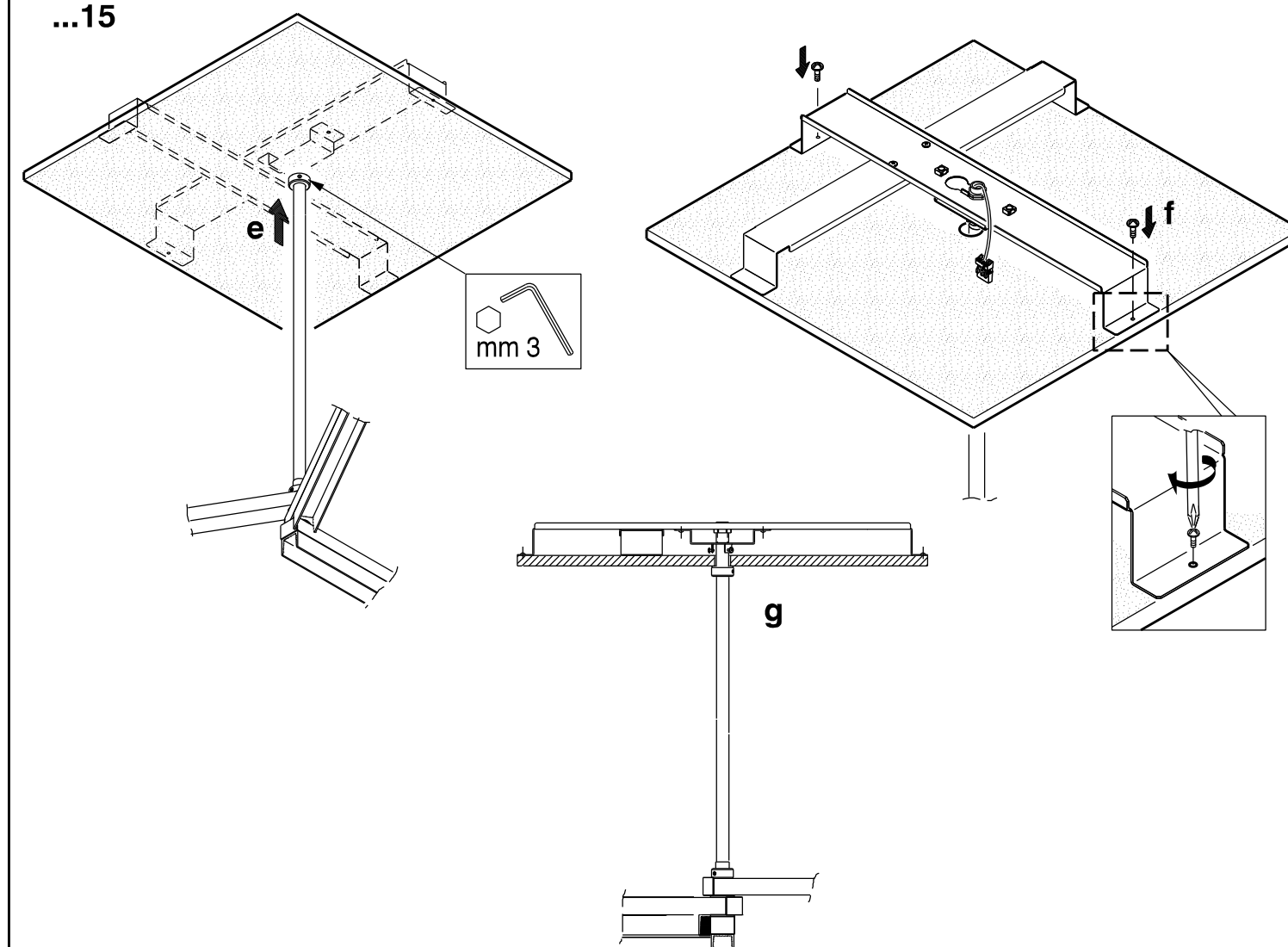

16

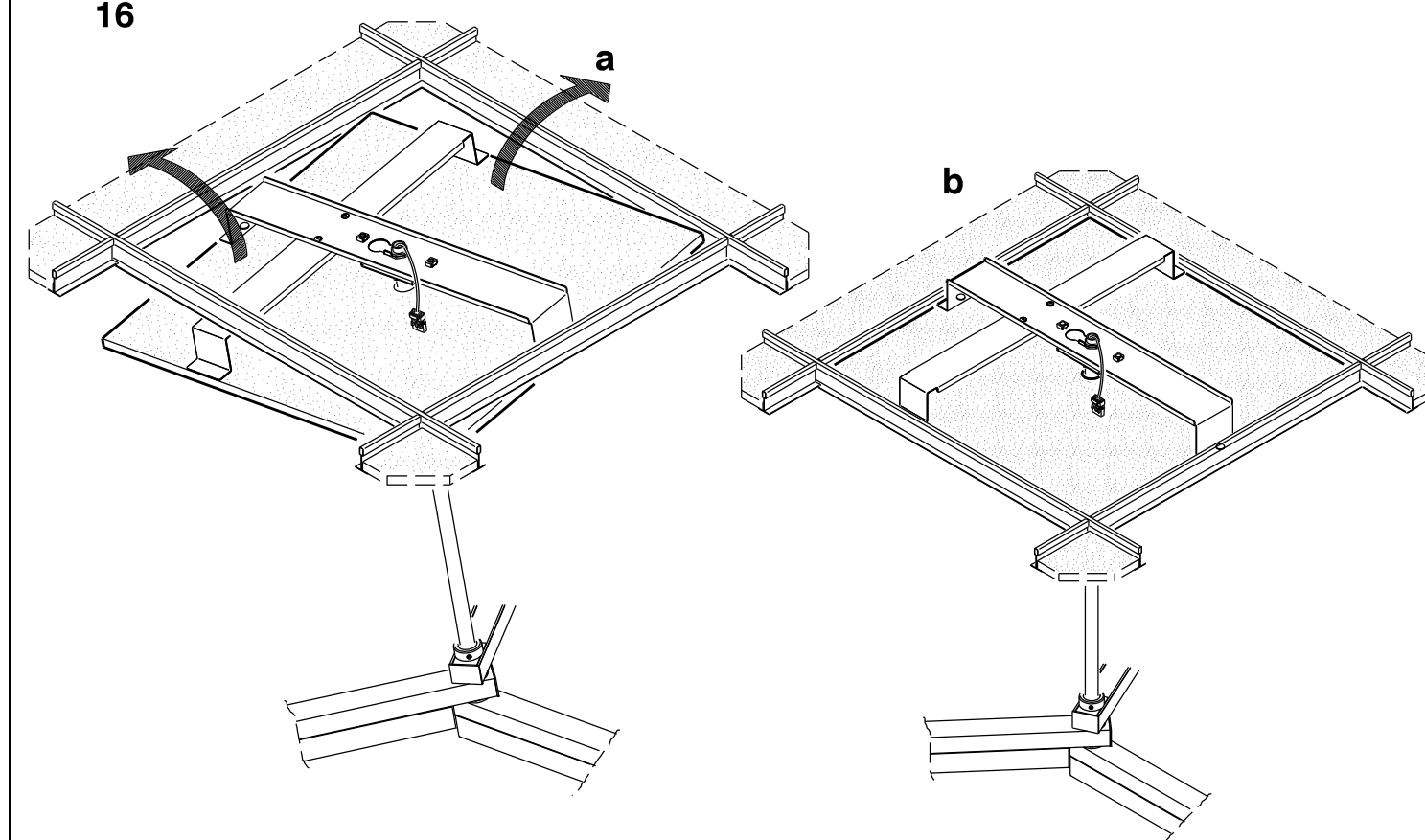

...16

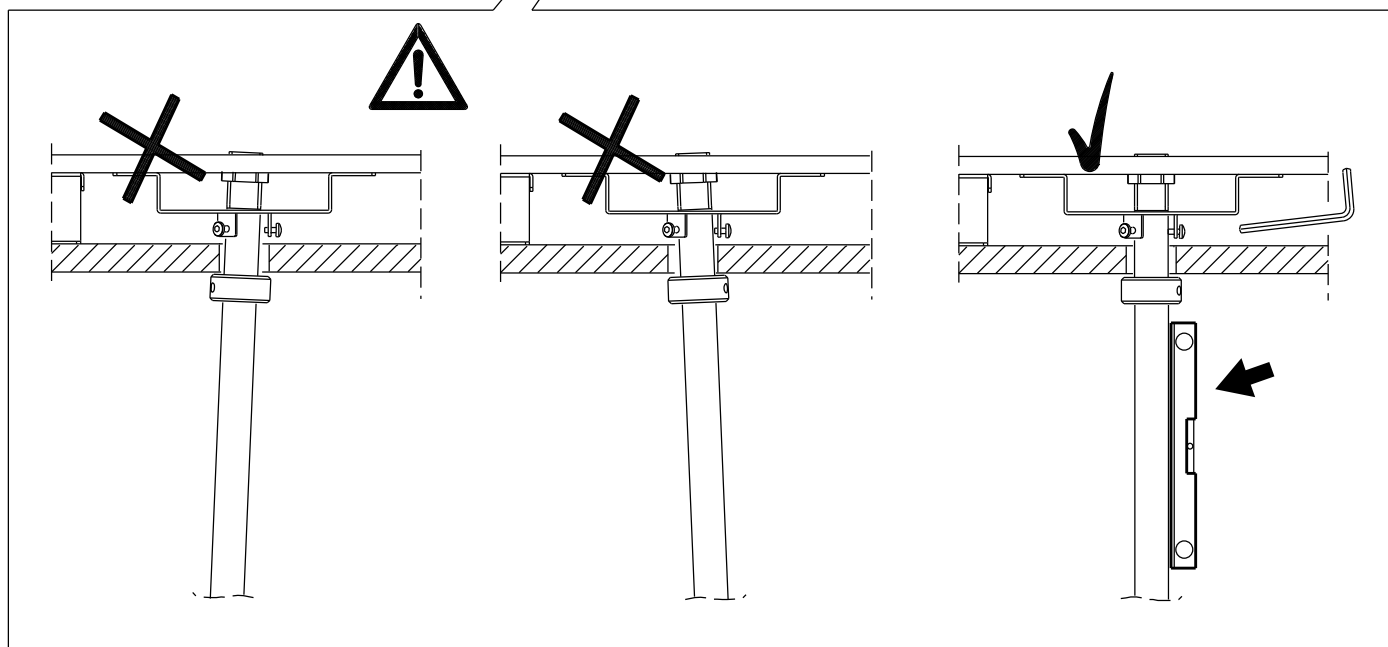
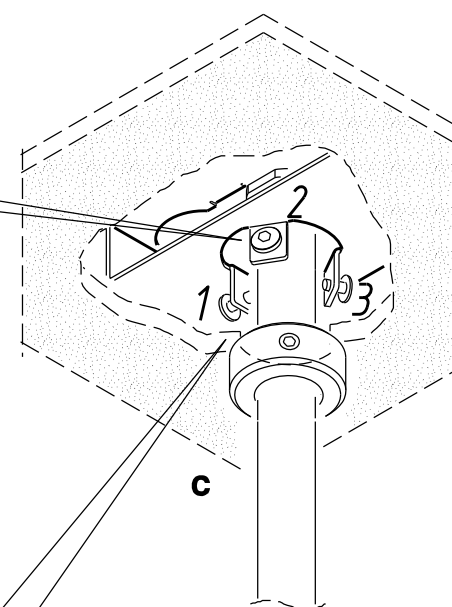
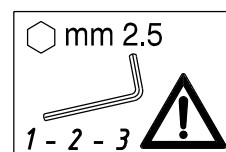
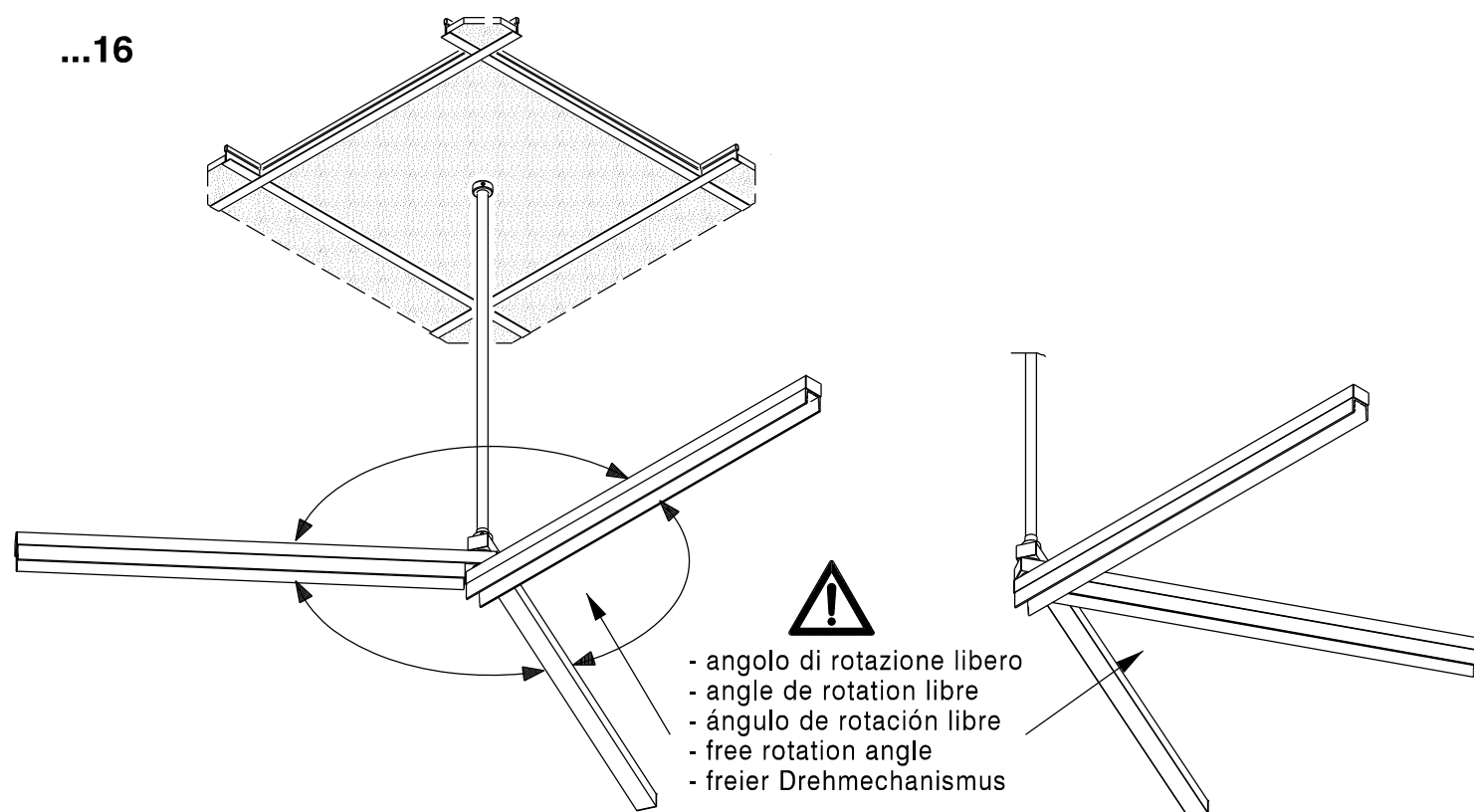

17

